

1. Summary

1) Character

BR/BP type of plate heat exchanger has many merits, such as little occupied area, simple structure, high heat exchange efficiency and easy to disassemble, etc; and the latest inlaid gasket ring is used to make the replacement of rubber gasket more convenient, the cleaning more through, and the maintenance easier. The skillful design for plate corrugation form strengthens the heat exchange efficiency.

2) Main application

BR/BP type of plate heat exchanger is used in heating and cooling for caloric -sensitive material, such as dairy, beverage, fruit juice, sauce, etc. It is popular with dairy producer.

3) Operating condition

a) The heating and cooling medium has no causticity on stainless steel

b) Working pressure

1MPa / 0.6MPa(BP)

c) Working temperature:

gasket in NBR100°C

gasket in EPDM< 140t

gasket in Europe EPDM140°C

gasket in FPM160°C

2. Structure and working principle

1) Structure

BR / BP type is made by plates and gaskets in arranged combination, together with fixed impaction plate, intermediate lamella, movable impaction plate, top / bottom leader, clamp bolt, inlet / outlet material pipes, sealing elements.

2) Working principle

The gaps between plates build up flow passages. In order to exchange heat for sterilization, material and medium flow through the adjacent passages continuously, but they will not infiltrate or mix between each other.

3. Installation and debugging

1) After placing, you can start to connect pipelines for material, medium and others according to the marks on equipment.

To guarantee the reliability and security during the operation, and avoid liquid pressure protean during transportation and damage on sealing elements, there should be equipped with a control valve or pressure gauge on material inlet and cooling water inlet.

2) Before operating, feed treated water at 80 - 85CC and keep circulation for 40 min. If there is any leakage, pls. loose the clamp step by step.

3) In accordance with working condition, technical performance and requirements, the set can be equipped with appropriate pump by user.

4. Operation

1) Before operation, feed hot water at 85 - 90t to clean the equipment inside, and keep for more than 10 min.

2) Starting medium pump (hot water pump or cooling pump), then starting material pump after equipment surface fully heated or cooled. Feeding material for heating or cooling, and after water fully blown off from plates, feed material into temp storage tank.

3) After production, user must wash and disinfect the whole system exhaustively as following:

Feed clean water to make leftover fully blown off, and heat 1 - 1.5%NaOH liquid to 85CC and keep circulation for 15 min. Keep feeding clean water to make alkali liquid fully blown off until it looks clean.

5. Maintenance and store

1) According to the using situation, on a regular basis to open the plate heat exchanger, and check the efficiency bof plates. If there is any leftover, you can clean plates by palm brush; nitric acid liquid can be used for washing, and make the installation after washed by clean water.

2) Equipment use after a certain period of time, as a result of the gasket natural aging, rubber mat update work must be conducted. Gaskets will be removed after add within 100 t hot water soak 10 to 20 minutes, make its restore certain elasticity, and then continue to use wash on heat transfer.

3) Plates can not be clamped too tight, otherwise leakage may occur. All plate must be arranged according to the code on plates.

4) Handle with care, prevent from dumping, violent vibration and strictly forbid collision.

5) Store site must be breezy, dry, environment sweeps, and can not be stored together with material with causticity. Loose clamp, and keep the space between impaction plates at 1.05 L ("L" is the dimension standard for the product).

6. The appended drawing

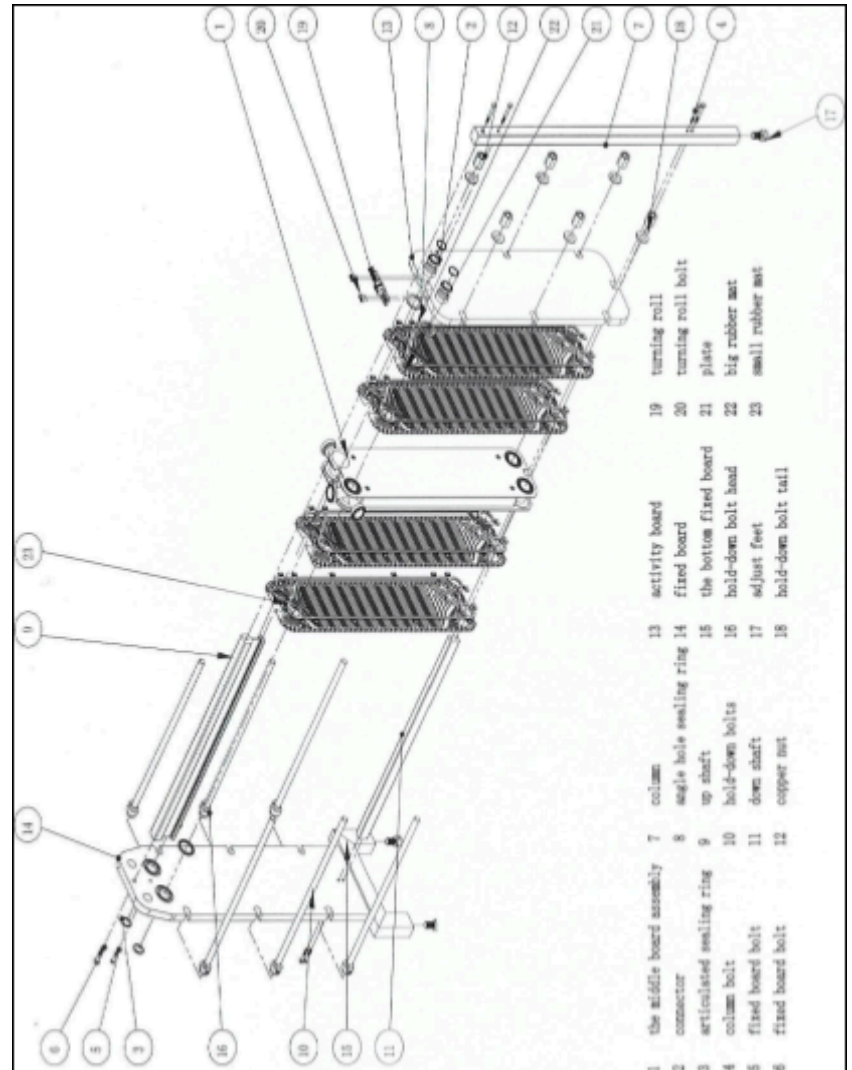

装箱单

名称: 板式换热器 型号规格 BR1.2D-J-5B 出厂编号 NH24062816A-2

序号	名称	型号规格	数量	备注
1	板式换热器	BR1.2D J 5B	1	板片316L
2	产品合格证		1	
3	使用说明书		1	
4	装箱单		1	
5	板片橡胶垫	BR1.2D-J-5B	4	三元乙丙
6	角孔密封圈	BR1.2D	4	
7	卡式O型密封圈	φ38	4	
8	卡式接头	φ38~φ25	4	
9	卡箍	φ38	4	
10	棘轮扳手	M20	1	

装箱/日期: 戴国林 2024.7

制单: 吴莉莎

检验/日期: 陈强 2024.7